

**RESOLUTION NO. 018-2021
RESOLUTION TO ADOPT WARD PLAN AND TO
DESIGNATE POLLING PLACE**

WHEREAS, the *Town* of Clearfield of Juneau County, Wisconsin, is required to establish wards in accordance with Section 5.15 of the Wisconsin Statutes; and

WHEREAS, Section 59.10(3)(b) of the Statutes requires that each County Board adopt and transmit to each municipal governing body in the County a tentative County Supervisory District Plan, and the *Town* of Clearfield has received a copy of said plan; and

WHEREAS, Wisconsin Statutes require that each municipality designate the various ward(s) to be created within the municipality.

NOW THEREFORE BE IT RESOLVED, that the Board does hereby create 1 ward as follows:

Ward 1 – which shall be a portion of County Board Supervisory District #13 with a population of 762. *See attached Map.*

BE IT FURTHER RESOLVED that the above ward boundaries are outlined and identified on the attached map, which is incorporated herein by reference.

BE IT FURTHER RESOLVED that for all voting purposes, the above ward will be combined, using one common polling place, which will be Clearfield Town Hall N8111 8th Avenue, New Lisbon, WI 53950, as located in Ward 1.

Approved and adopted this 12th day of October 2021.

Ayes 3 Nays 0 Abstain 0 Absent 0 Voice Vote

OFFICIALS SIGNATURES

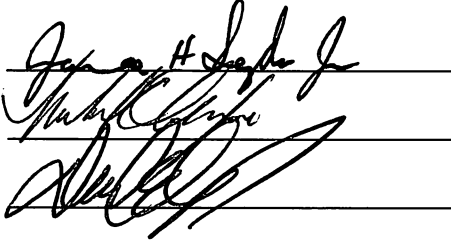

I hereby certify that the above resolution was adopted by the *Town* of Clearfield Board of Supervisors at a regular meeting held on the 12th day of October 2021.

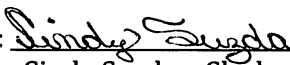
Signed by: 
Cindy Suzda – Clerk
Town of Clearfield

Plan 1, Modification 1
Superior Districts
Juneau County, Wisconsin

Clearfield
District 13

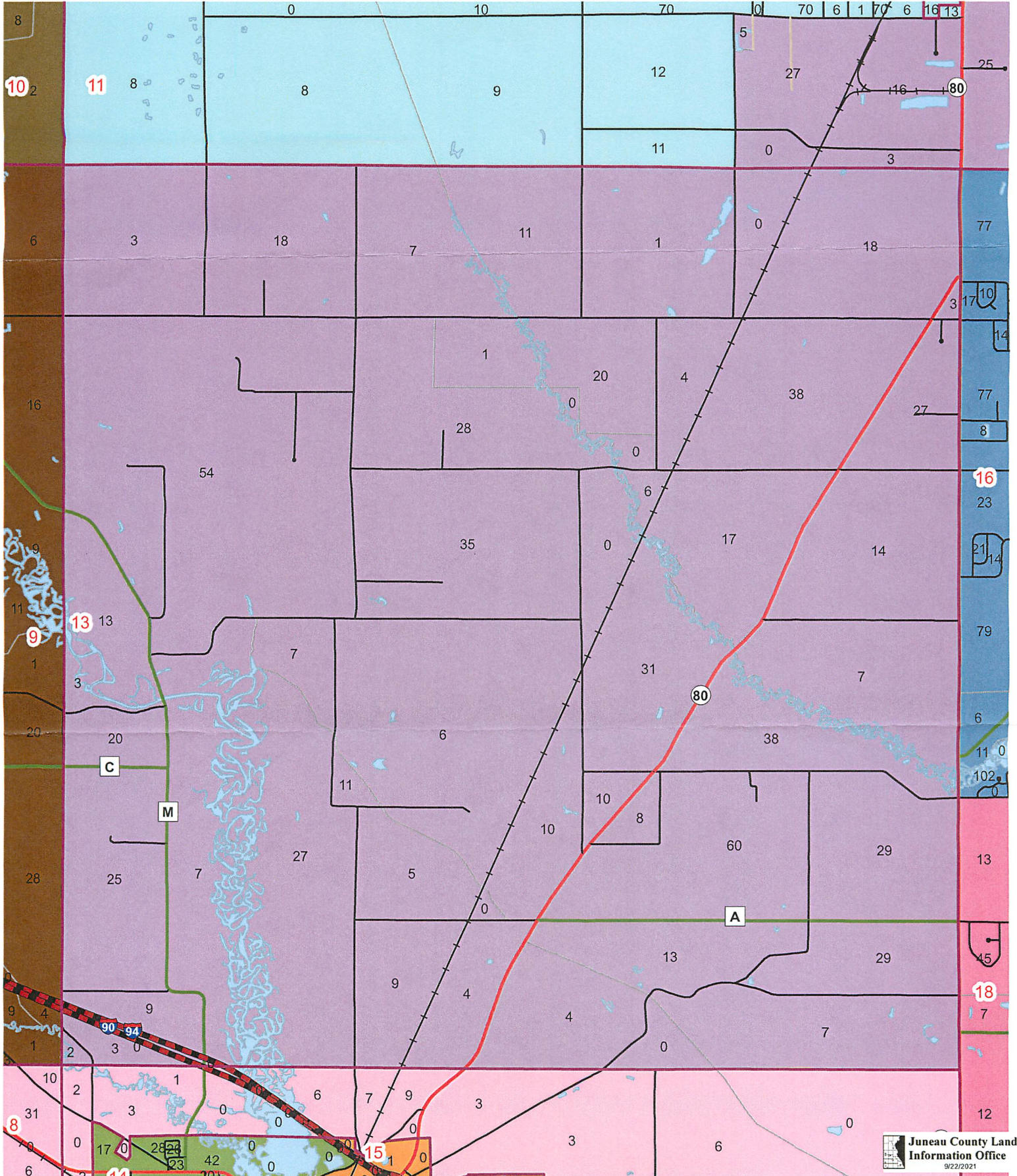

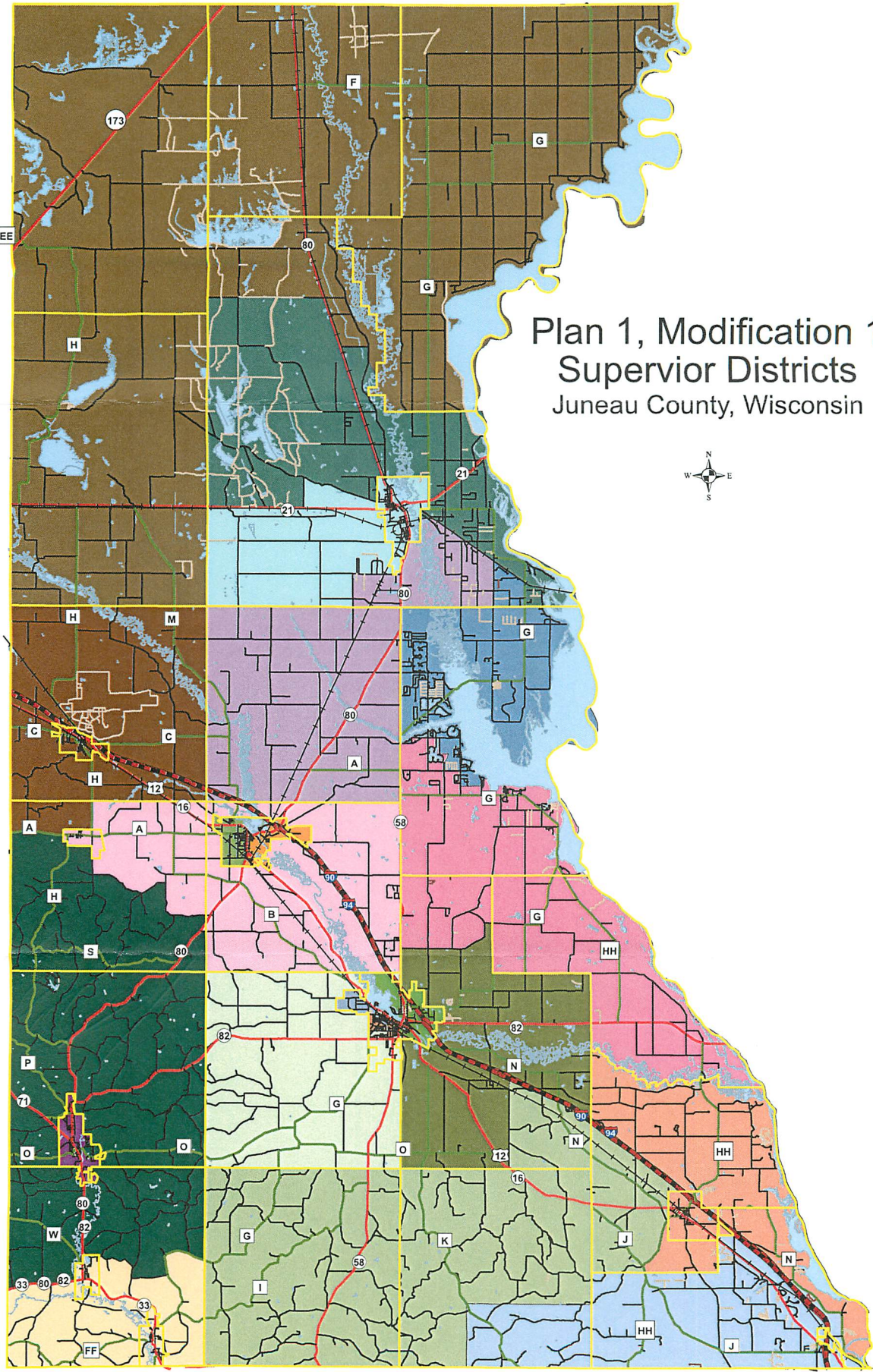

Plan 1, Modification 1 Superior Districts Juneau County, Wisconsin

